

P1

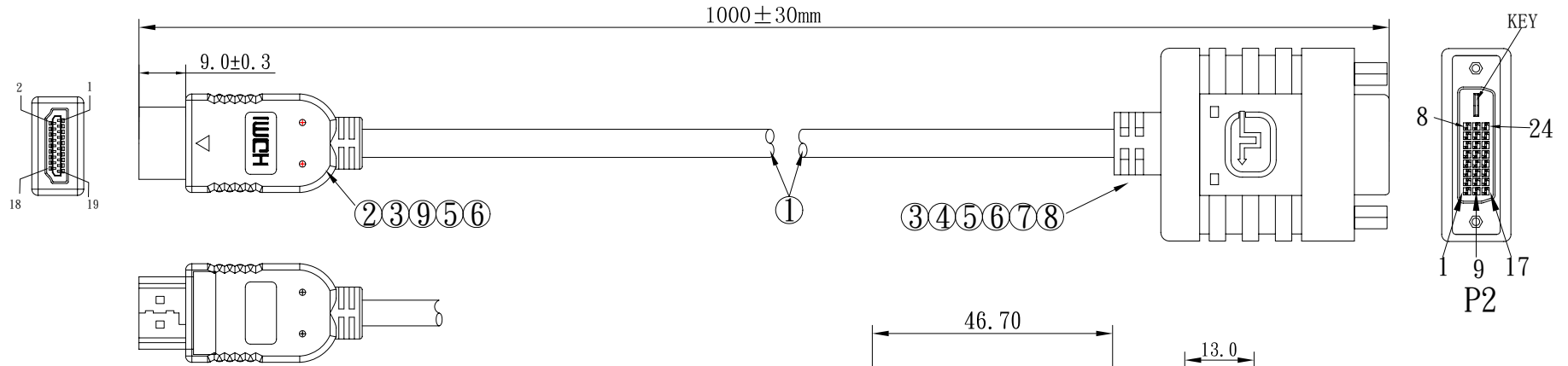

NO	DESCRIPTION	MATERIAL	SUPPLIER	REMARK
1	CABLE	UL 20276(#30*1P+EAM)*4+ #30*5C+MAB 85% OD : 5.5mm CLR-006 BLACK	GM	*
2	CONNECTOR	HDMI 19P A公鍍殼鍍線端子G/F 膠芯黑色 #90113801	YALIAN	21-033-061-04A
3	PE	PE CLEAR	GLORY MARK	41-001-034
4	PVC	CLR-006 BLACK SHORE A 88±2	GLORY MARK	41-001-006
5	TUBE	UL/CSA 125°C VW-1(F4) 300V φ2.0mm BLACK	WOER	42-A002001
6	COPPER FOIL	W25*T0.04mm	HE YI	32-001-001
7	CONNECTOR	DVI 25 FEMALE+NUT PIN G/F 铁壳鍍線	Tai Wei	21-002-088
8	TUBE	UL/CSA 125°C VW-1(F4) 300V φ1.0mm BLACK	WOER	42-A001003
9	PVC	CLR-002 GRAY SHORE A 88±2	GLORY MARK	41-001-002

NOTES:

1. 100%OPEN, SHORT & MISWIRE TEST.
2. PAY ATTENTION TO PIN ASSIGNMENTS.

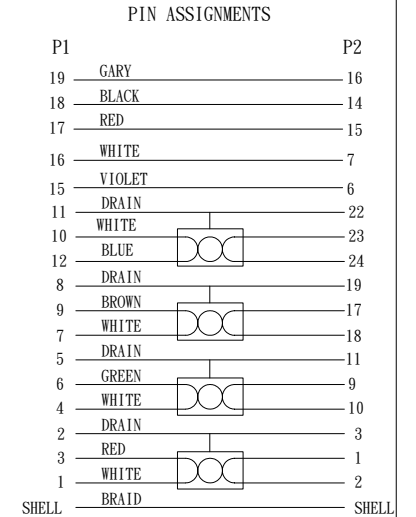

TOLERANCES			REVISIONS				COMPONENT NO :		
X .	+	mm	REV	DESCRIPTION	DATE	APPVD.	HDMI TO DVI-D 变换 CABLE L=1M		
X . X	-	mm	0		3-8-16	LI	APPROVED :		
X . XX	+	mm					CHECKED :		
X . XXX	-	mm					DRAWN :Liu Wei		
METRIC (mm)							DATE: MAR-8-16		
							TITLE : CABLE ASS' Y		
							REQUIRED DOCUMENTS : *		
							SCALE : /	SHEET : 1 / 1	REV: 0
							DRAWING :		
							FILE :	THIRD ANGLE PROJECTION	